

# TECHNICAL DATA

**LIBERTY HARDWARE®**  
MANUFACTURING CORPORATION

A Masco Company

140 Business Park Drive • Winston-Salem, NC 27107  
800.542.3789 • T 336.769.4077 • F 336.769.1839  
www.libertyhardware.com

## SHOWER ROD 176 Series

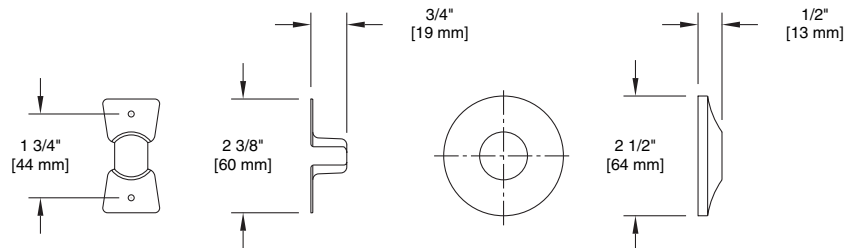

MODEL#	DIM "A"
176	5', 6"
176H	5', 6"
176HP	5', 6"
177	5', 6"
177H	5', 6"
177HP	5', 6"

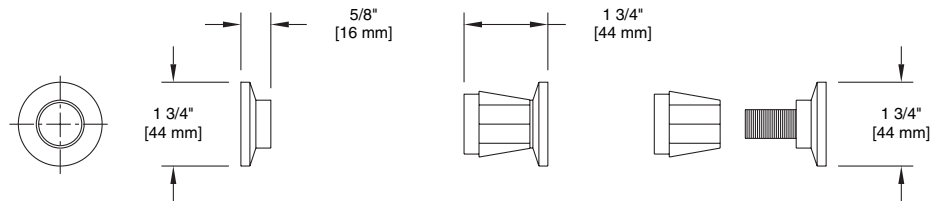
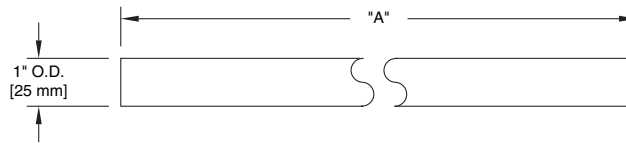

**MATERIALS:** 176 tubing is of 1" O.D. X .015 (28 gauge) type 430 polished stainless steel. 177 tubing is of 1" O.D. x .015 (28 gauge) bright aluminum. Flanges for 176 and 177 are galvanized steel hanger type with concealed screw type 430 polished stainless steel covers. Holders for 176H and 177H are chrome plated zinc die cast (Zamak) adjustable tension mount type with rubber discs. Holders for 176HP and 177HP are chrome plated ABS plastic adjustable tension mount type with rubber discs.

**INSTALLATION:** Install hanger type flanges and rod with 4-#8 X 1 1/4" roundhead zinc plated steel screws provided. Cover flanges to be on rod before installation of hangers and rod. Slide cover flanges over hangers to complete installation. Install adjustable tension mounted holders and rod by sizing rod 1 5/8" shorter than wall opening. Insert rod into holders and tighten into position with counterclockwise motion on threaded holder until secure. Wood blocking is preferable behind all wall surfaces where screw-in installation is used (176, 177). If wood blocking is not available, the following optional fasteners are suggested:

Tile/Masonry - Plastic or lead anchors  
Plaster/Drywall - Toggle bolts

**SPECIFICATION:** Surface mounted shower rod shall be model \_\_\_\_\_ (fill in model number and length) by Liberty Hardware Manufacturing Corporation.