

Tempra[®]

DOUBLE ROBE HOOK

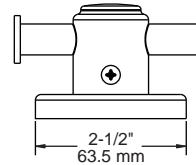
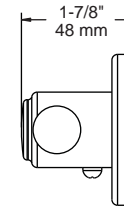
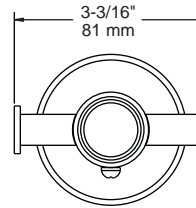

MATERIALS: Wall Flange and Projecting Post - Stamped Brass
Wall Plate - 1/8" Thick Die Cast Zinc with 1" Diameter Projecting Stud

INSTALLATION: Mount wall plate bracket(s) per installation instructions with supplied fasteners. Slip product over wall plate(s) and tighten set screws until secure.

OPTIONAL FASTENER INFORMATION:
Wood blocking is preferable behind all wall surfaces. If wood blocking is not available, the following fasteners are suggested: Tile/Masonry - Plastic or Lead Anchors, Plaster/Drywall - Toggle Bolts.

SPECIFICATION: Surface mounted double robe hook shall be model _____
(fill in model number) by Liberty Hardware Manufacturing Corporation.

FranklinBrass[®]
A Liberty Hardware Brand